

TOWN OF RHINEBECK

AGRICULTURAL DATA STATEMENT

Project Tax Map Number: 135089-6170-00-223336

In accordance with Section 283-a of the New York State Town Law, and Section 305-a of the Agricultural and Markets Law, the Town of Rhinebeck will use the data in this statement to assist in evaluating the impacts of the proposed development projects on/in the Agricultural Use Districts.

Applicant Name: Kearney Realty & Development Group Inc.

Mailing Address: 57 Rout 6, Suite 207, Baldwin Place, NY 10505

1. Description of proposed project:

Proposed construction of 6 multi-family dwellings and associated infrastructure.

2. Type of Approval sought from the Town:

Special Use Permit Site Plan Approval

Subdivision Approval Use Variance

Other (explain) _____

3. Project Location: Rhinecliff Road

4. Tax Map Number: 135089-6170-00-223336

5. Number of Total Acres involved with project: 23.3 ac

6. Number of Total acres presently in tax account: 23.3 ac

7. Is any portion of the subject site currently being farmed?

Yes No If so, how much? _____ Acres

8. Please identify who is farming the subject site: N/A

9. Does this person own or rent the land? Own Rent

10. The slope of this site is 0% to 60%

(this information can be obtained from the Dutchess County Soil and Water Conservation District)

11. Please indicate intentions for the use of the remainder of this property:

All undeveloped acreage will remain woodlands.

12. Who will maintain the remainder of the property not being used for this development?

Property owner

13. Other project information. Please include information about the existing land cover on the site, any known impacts on existing storm water drainage (including both field titles), other significant plant materials.

The existing land cover for the project site is undeveloped forest. The proposed design has taken into account stormwater and a SWPPP has been developed to mitigate any potential adverse affects from development.

14. Please attach a list of the names and addresses of any owners of land within an agricultural district containing farm operation located within 500 feet of the boundary of the property on which the project is proposed, and the tax parcel number(s) of the farm parcel(s). This information can be obtained from the Town Assessor.

15. Please attach a copy of the overall parcel from the Town's Tax Maps. Identify the site of this application with an "X" and mark the farm parcels within 500. Include the tax map with the completed agricultural data statement.

I hereby confirm that all of the above stated information is both accurate and complete to the best of my knowledge.

Applicant's signature:  Date 5/9/2024

14. Tax #: 135089-6170-00-148140
Bernard R. Scholldorf
108 Rhincliff Rd
Rhinebeck, NY 12572

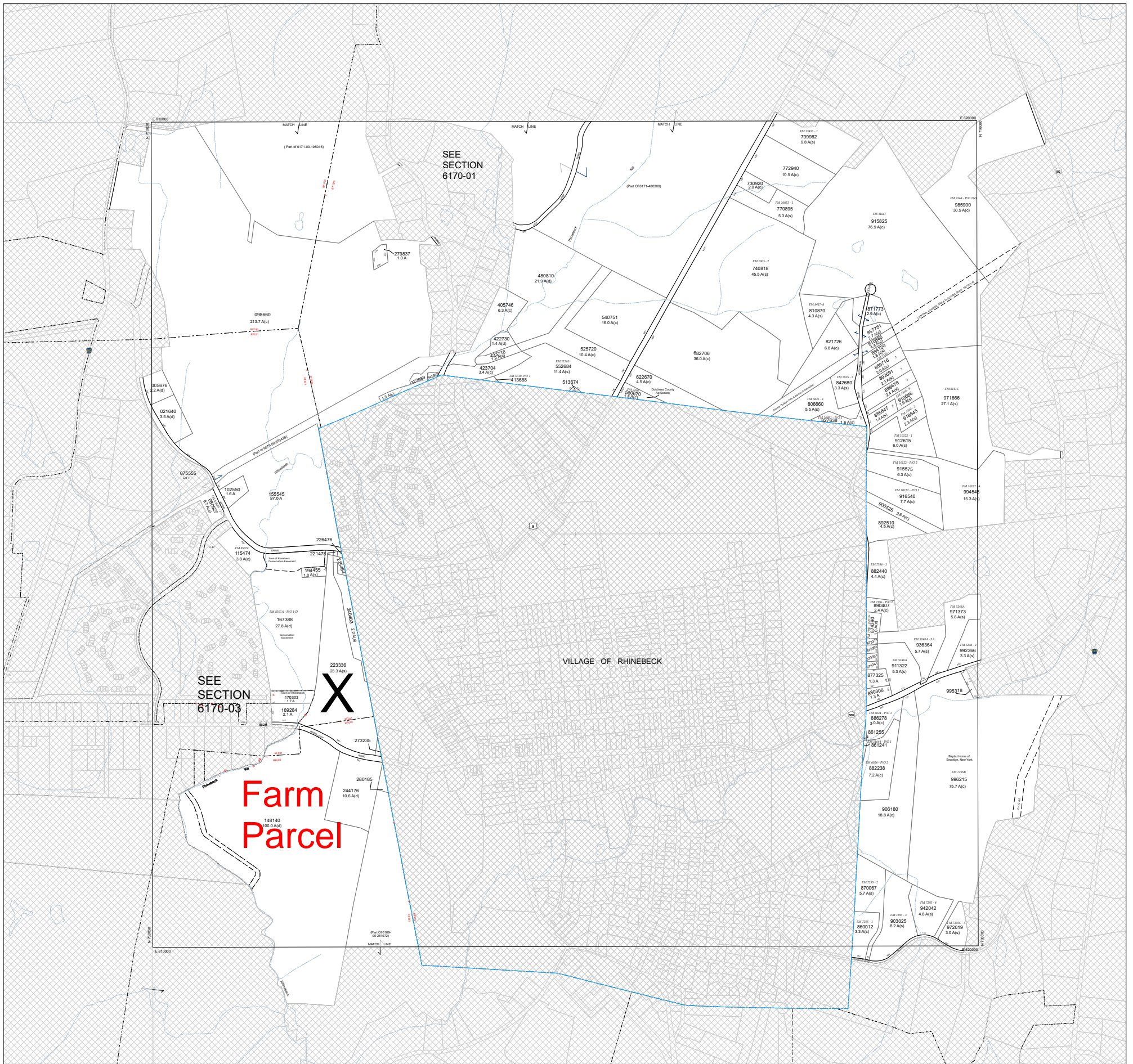

REAL PROPERTY MAP

FOR TAX PURPOSES ONLY
 NOT TO BE USED FOR CONVEYANCE. ABSOLUTELY NO ACCURACY OR COMPLETENESS
 GUARANTEE IS IMPLIED OR INTENDED. ALL INFORMATION ON THIS MAP IS SUBJECT TO
 SUCH VARIATIONS AND CORRECTIONS AS MIGHT RESULT FROM A COMPLETE TITLE
 SEARCH AND / OR ACCURATE FIELD SURVEY.

MAINTAINED BY DUTCHESS COUNTY
 REAL PROPERTY TAX SERVICE AGENCY

SPECIAL DISTRICTS

| District | Code | Name | District | Code | Name |
|----------|-------|---------------------|----------|--------|------------------|
| Fire | RF030 | Rhinebeck Fire Prot | School | 135001 | Rhinebeck CSD |
| Fire | RF031 | Rhinecliff Fire | Water | RW002 | Rhinecliff Water |
| Light | RL063 | Rhinecliff Light | | | |

SPECIAL DISTRICTS

| | | | |
|-----------|-------|--------|---------|
| AMBULANCE | --A-- | PARK | --P-- |
| DRAINAGE | --D-- | ROAD | --R-- |
| FIRE | --F-- | SEWER | --S-- |
| HYDRANT | --H-- | SCHOOL | --SCH-- |
| LIBRARY | --L-- | WATER | --W-- |
| LIGHT | --L-- | | |

LEGEND

| | |
|----------------------------|-----|
| PROPERTY LINE | --- |
| MUNICIPAL BOUNDARY | --- |
| ROAD OR RAILROAD ROW | --- |
| EASEMENT ROW | --- |
| DATUM LINE (MAPSHEET LINE) | --- |
| WATER | --- |

| | |
|----------------------------|---------|
| TAX MAP PARCEL NUMBER | 00000 |
| ACREAGE (FROM DEED) | 1.0 AC |
| ACREAGE (CALCULATED) | 1.0 AC |
| ACREAGE (FROM SURVEY) | 1.0 AC |
| DIMENSION (DEED OR SURVEY) | 16.0 |
| DIMENSION (CALCULATED) | 60'0" |
| STREET OR TOWN ROAD | BY NAME |

| | |
|------------------------|------------------|
| U.S. HIGHWAY | --- |
| INTERSTATE HIGHWAY | --- |
| NEW YORK STATE HIGHWAY | --- |
| COUNTY HIGHWAY | --- |
| LAND HOOK | --- |
| F.M. 0000 | FILED MAP NUMBER |

| | | |
|------|------|------|
| 6071 | 6171 | 6271 |
| 6070 | 6170 | 6270 |
| 6069 | 6169 | 6269 |



TOWN OF RHINEBECK
 DUTCHESS COUNTY, NEW YORK

DATUM: NAD 1927
 TAXABLE STATUS DATE: MARCH 1, 2023
 PRINTED DATE: 4/27/2023
 REVISION DATE: 01/04/2021

6170.00